

PLOTTED ON: 10/31/2016

DESIGN FILENAME: P:\111\38\01\Design\Civil\Roadway\1113801\_SanAntonioSt\_12.dgn

MATCH LINE STA

MATCH LINE STA

MATCH LINE STA

MATCH LINE STA

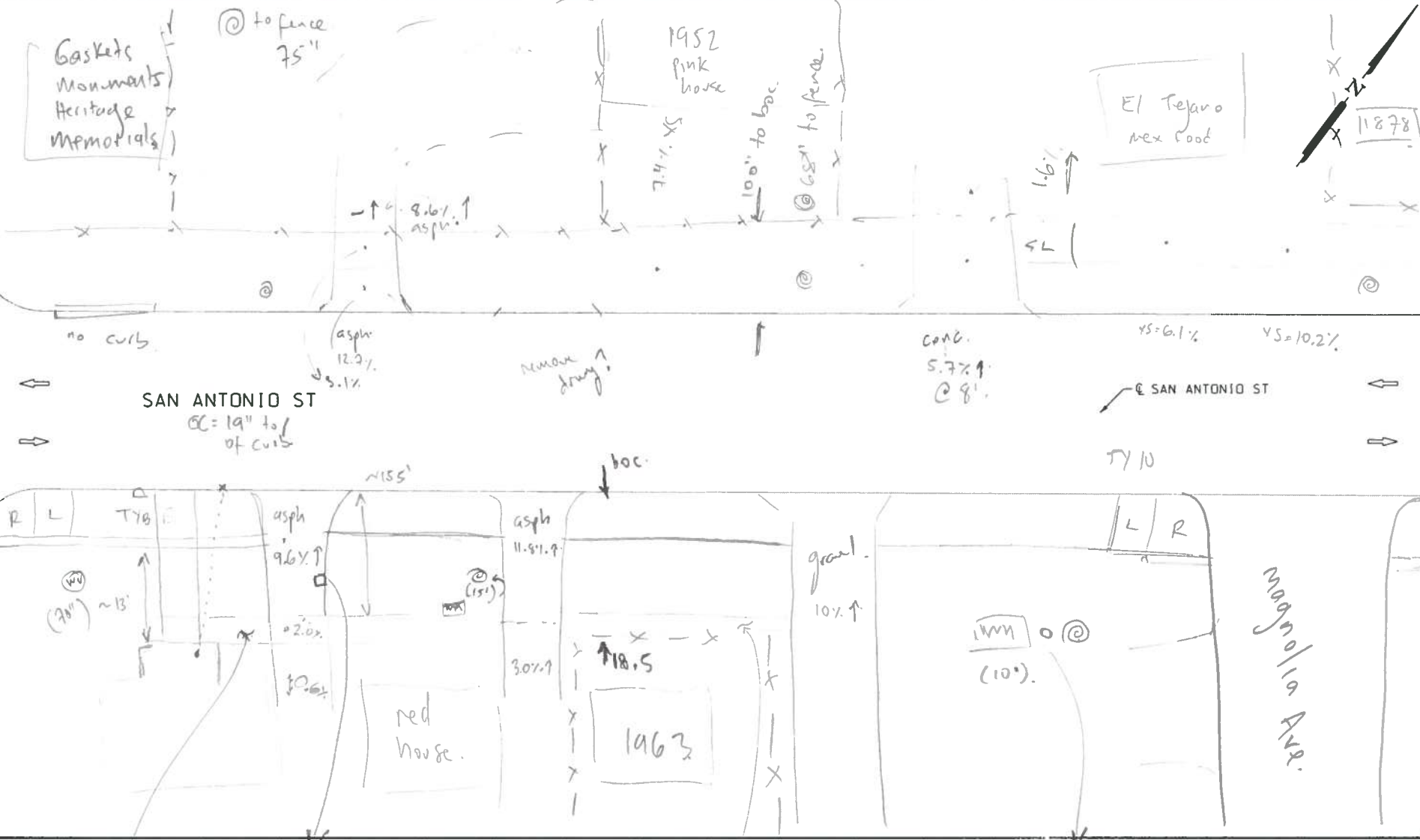

ITEM	DESCRIPTION	UNIT	QTY
------	-------------	------	-----

AW 11/7  
PD



NB\_15-054\_SA\_12

DESIGN  
**INTERIM REVIEW**  
 DOCUMENT INCOMPLETE. NOT INTENDED FOR PERMIT, BIDDING OR CONSTRUCTION.  
 ENGINEER: JOHN A. TYLER  
 P.E. SERIAL NO: 105193  
 DATE: 10/31/2016

REVIEW AND APPROVAL  
**INTERIM REVIEW**  
 DOCUMENT INCOMPLETE. NOT INTENDED FOR PERMIT, BIDDING OR CONSTRUCTION.  
 ENGINEER: JAMES A. LUTZ  
 P.E. SERIAL NO: 84722  
 DATE: 10/31/2016

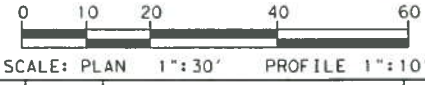

REV. NO.	DATE	DESCRIPTION	BY
----------	------	-------------	----

**Pape-Dawson ENGINEERS**

SAN ANTONIO | AUSTIN | HOUSTON | FORT WORTH | DALLAS  
2000 NW LOOP 410 | SAN ANTONIO, TX 78213 | 210.375.9000  
TDPF FIRM REGISTRATION #470 | TDPIS FIRM REGISTRATION #1002800

Texas Department of Transportation  
© 2016

HIGHWAY

SAN ANTONIO ST

STA XXX+XX TO STA XXX+XX

SHEET 12 OF 15

DGN:	FED. RD. DIV. NO.	STATE	PROJECT NO.	HIGHWAY NO.
CHK:	6	TEXAS		VA
DWG:	DIST.	COUNTY	CONT. NO.	SECT. NO.
CHK:	SAT	COMAL		

48